



BZXM/MH SERIES

Housing and plate made of zinc-plated, pressed steel with double ball race in swivelhead.

Available with top plate or single bolthole fixing.

WHEEL CODE

Wheel diam or (mm) Swivel fixed

Tread width (mm)

Overall height (mm)

Plate type

Swivel radius (mm)

Bearing type

AN*

300C black phenolic

TP

300C thermoplastic

RNHT

250C black elastic rubber on phenolic

80	S	35	113	A	80		BZMH80AN3 150kg	-	-	
							BZMH80AN3TF 150kg	-	-	
80	F	35	113	A	-		BZMHF80AN3 150kg	-	-	
							BZMHF80AN3TF 150kg	-	-	
100	S	30 AN=35	133	A	92		BZMH100AN3 180kg	BZMH100TP3 150kg	BZMH100RNHT 110kg	
							BZMH100AN3TF 180kg	BZMH100TP3TF 150kg	BZMH100RNHTTF 110kg	
							BZMH100ANBJ3 180kg	BZMH100TPBJ3 150kg	BZMH100RNBJHT 110kg	
							BZMHF100AN3 180kg	BZMHF100TP3 150kg	BZMHF100RNHT 110kg	
100	F	30 AN=35	133	A	-		BZMHF100AN3TF 180kg	BZMHF100TP3TF 150kg	BZMHF100RNHTTF 110kg	
							BZMHF100ANBJ3 180kg	BZMHF100TPBJ3 150kg	BZMHF100RNBJHT 110kg	
							BZMH100AN3LP 180kg	BZMH100TP3LP 150kg	BZMH100RNHTLP 110kg	
							BZMH100AN3LPTF 180kg	BZMH100TP3LPTF 150kg	BZMH100RNHTLPTF 110kg	
100	S	30 AN=35	135	B	92		BZMH100AN3LP 180kg	BZMH100TP3LP 150kg	BZMH100RNHTLP 110kg	
							BZMH100AN3LPTF 180kg	BZMH100TP3LPTF 150kg	BZMH100RNHTLPTF 110kg	
							BZMH100ANBJ3TF 180kg	BZMH100TPBJ3LP 150kg	BZMH100RNBJHTLP 110kg	
125	S	40	158	A	107		BZMH125AN3 200kg	-	-	
125	F			158	A	-		BZMHF125AN3 200kg	-	-
125	S			160	B	107		BZMH125AN3LP 200kg	-	-

No brakes available on this castor series

100	S	30 AN=35	130	A	92		BZXM100AN3 150kg	BZXM100TP3 150kg	BZXM100RNHT 110kg
							BZXM100AN3TF 150kg	BZXM100TP3TF 150kg	BZXM100RNHTTF 110kg
100	F	30 AN=35	130	A	-		BZXM100AN3 150kg	BZXM100TP3 150kg	BZXM100RNHT 110kg
							BZXM100AN3TF 150kg	BZXM100TP3TF 150kg	BZXM100RNHTTF 110kg

No brakes available on this castor series

* also available to 350°C temperature specification
- details on request

Single bolthole castor (12mm)

add to code: **BH12**

WHEEL BEARING KEY

- Plain bore
- Teflon bush
- Ball journal

AVAILABLE WHEEL TYPES (for full wheel specifications refer to pages indicated)

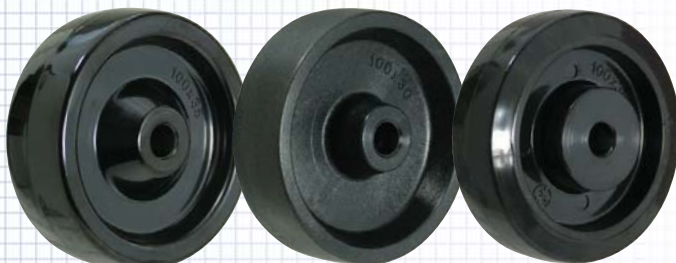

p82

p83

p83

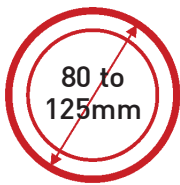

80 to
125mm



Bolt hole



110 to
200kg



Plate
fixing



110-200kg

PLATE TYPES AND DIMENSIONS (mm)

Type A

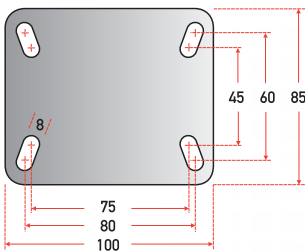

Type B

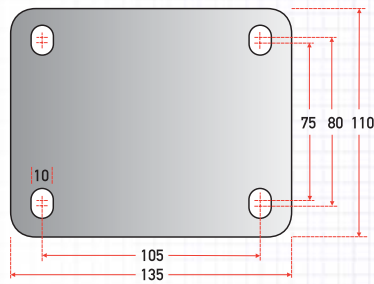

Single bolthole
add to code: BH12

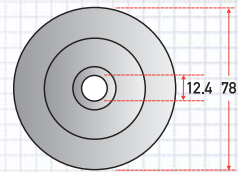

BZXM/MH SERIES HIGH TEMP

